

Axxis High Backrest

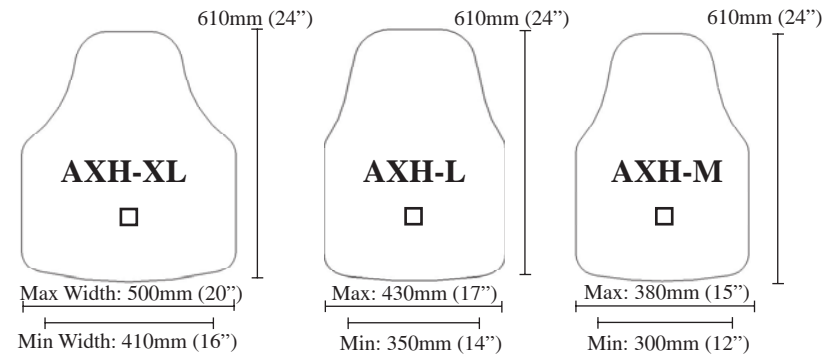

Axxis Standard Backrest

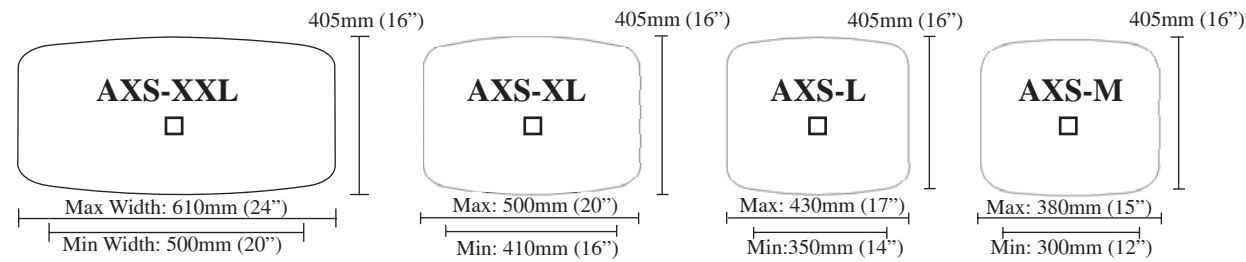

Axxis Reduced Height Backrest

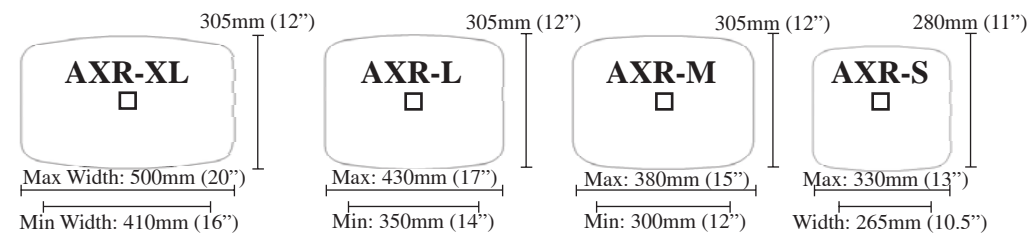

Axxis Segmented Backrests - Full & Reduced Height

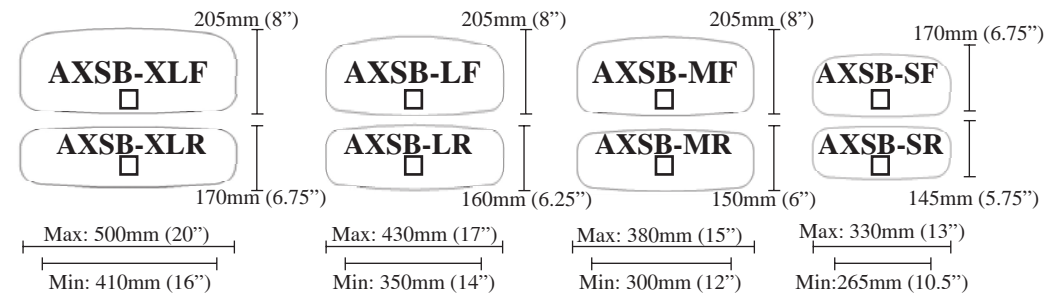

Backrest Extensions

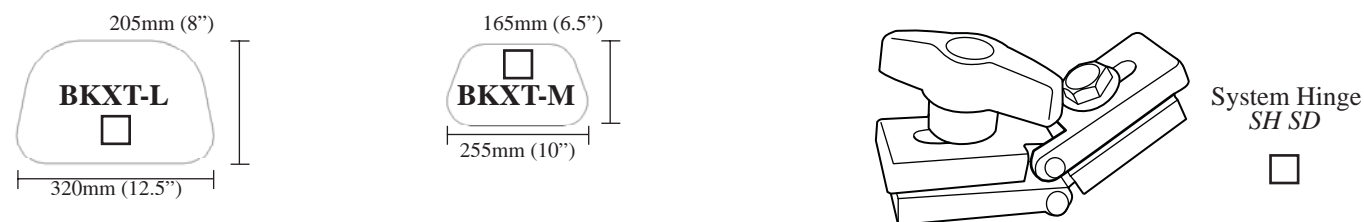

Mounting Block Kits (1 Pair)



- Universal Mounting Block Kit, (Europe) *MB-R-UE*
- Universal Mounting Block Kit, (U.S.A) *MB-R-US*
- Universal Mounting Block Kit, (Norway) *MB-UN*

Mounting Blocks (1 Pair)

- Mounting Blocks (16mm round tube) *MB-R-16*
- Mounting Blocks (20mm round tube) *MB-R-20*
- Mounting Blocks (22mm round tube) *MB-R-22*
- Mounting Blocks (25mm round tube) *MB-R-25*
- Mounting Blocks (32mm round tube) *MB-R-32*
- Mounting Blocks 45° (22mm square tube) *MB-D-22*
- Mounting Blocks 90° (22mm square tube) *MB-S-22*
- Mounting Blocks 16mm DD *MB-DD-16*
- Mounting Blocks 20mm DD (Tendercare) *MB-DD-20*
- Mounting Blocks 22mm DD (Roxx/Cougar) *MB-RX*
- Mounting Blocks 23mm DD (RJ101) *MB-RJ*
- Mounting Blocks NETTI (Netti 1 & 2) *MB-NT*
- Mounting Blocks ETAC (Fits Handles) *MB ET*
- Mounting Insert ETAC (Fits into Handles) *MI-ETAC*



- Badger Mounting Kit (Arms not required) *MB-BH*

Arms (1 Pair)

(The suggested sizes for any wheelchair width are shown in the Documentation)

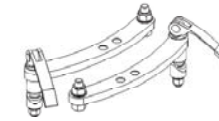

- V Trak Arms 100mm *AM-100*
- V Trak Arms 125mm *AM-125*
- V Trak Arms 150mm *AM-150*
- V Trak Arms 175mm *AM-175*
- V Trak Arms 200mm *AM-200*
- V Trak Arms 225mm *AM-225*
- V Trak Arms 250mm *AM-250*

Central Mount



- Standard Central Mount *CM-STD2*

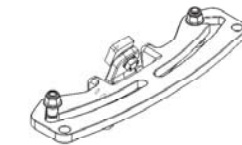

- Aluminium Universal Central Mount *CM-U*

Central Mounting Assembly (pre-assembled and includes Arms)

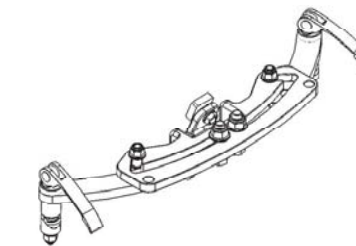

- Aluminium Central Mount & 100mm Arms *CMA-100*
- Aluminium Central Mount & 125mm Arms *CMA-125*
- Aluminium Central Mount & 150mm Arms *CMA-150*
- Aluminium Central Mount & 175mm Arms *CMA-175*
- Aluminium Central Mount & 200mm Arms *CMA-200*
- Aluminium Central Mount & 225mm Arms *CMA-225*
- Aluminium Central Mount & 250mm Arms *CMA-250*

Special Seating Components

- Sports Trak Kit (375mm) *VT L*
- Standard Trak Kit (417mm) *VT S*
- Long Trak (930mm) *VT H*

- Secondary Arm (15") *BM SSS 15*
- Secondary Arm (17") *BM SSS 17*

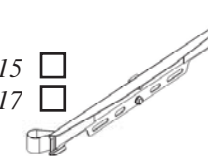

- Special Seating Trak (655mm) *VT SS*



- Harnessing Kit for Arm

ORDER FORM

V-Trak Headrests

3 Way, inc Bead Bag
HS SC

6 Way Adjustable
HS AC

6 Way, Winged
HS AW

6 Way, Large Winged
HS AWL

6 Way, Adjustable chassis
for axxis segments
HS CH

Accessories for 3rd party headrests

HAP AEG
Headrest adapter plate

HAP ATT
Harness Attachment kit

Example

HAP AEG + HAP ATT
Headrest adapter plate
Accepts 3rd party
Headrest blocks

Headrest Accessories

Headrest Adaptor for

14mm square tube *HA 14*

17mm square tube *HA 17*

20mm square tube *HA 20*

Extension Trak *BM HX*

Quick Release Kit with depth stop. Fits most headrests *HA QRK*

DELIVERY ADDRESS:

.....

.....

.....

.....

.....

POSTCODE:.....

TEL:..... Fax:.....

CONTACT:.....

Client Ref No:.....

It is **NOT** necessary to fill in this portion, but these details would allow the supplier to double check the prescription. The Service will be contacted if there are anomalies.

Client Details

Name :.....

Condition :.....

Date of Assessment :.....

Wheelchair Details

Model :.....

Seat Width :..... Seat Depth :.....

The V-Trak Axxis systems can be supplied complete as boxed systems with all the necessary components to fit onto a wheelchair with round backrest tubes of diameters between 19mm and 25mm (3/4" and 1"). To order these systems, please refer to the Axxis and Comfort Order Forms .

However, to achieve a more comprehensive postural management solution and/or to accommodate different sizes/sections of backrest tubes, or where seat widths and backrest sizes do not coincide, each component can be specified as an individual item from the V-Trak Classic range. This includes discontinued items that are supported for spares and servicing.

Example: 500mm (20") Low, Extra Large Axxis Backrest to be used in a 430mm (17") wheelchair to provide greater depth of lateral support. Tube diameter - 22mm. Order as follows;

- 1 Axxis Low Backrest AXS-XL
- 1 pair Mounting Blocks MB R 22
- 1 Central Mount Assembly CMA-150 (working range 325 - 445mm (12.8 - 17.5")) as detailed on price list.

Example: 430mm (17") Low, Large Axxis Backrest to be used in a 460mm (18") wheelchair to provide integral lateral support. Tube diameter - 25mm. Order as follows;

- 1 Axxis Low Backrest AXS-L
- 1 pair Mounting Blocks MB R 25
- 1 Central Mount Assembly CMA-175 (working range 365 - 480mm (14.4 - 18.9")) as detailed on price list.

V-Trak Accessories

Harness Carrier (1 pair) *BM AHC*

Cushion Retainer *BM ACR*

Shell Stabilising System (1 pair) *BM STA*

Extended Shell Stabilising System (1 pair) *BM STX*

Recycling Kit *BM ARK*

Harnessing Kit for Arm System *BM AHK*

Original Secondary Arm System

To Fit 15" wide Backrest *BM SAS 15*

To Fit 17" wide Backrest *BM SAS 17*

New Secondary Arm System with Thoracic Mount provision

To Fit 13" wide Backrest *BM SAT 13*

To Fit 15" wide Backrest *BM SAT 15*

To Fit 17" wide Backrest *BM SAT 17*

V-Trak Thoracic Support (Thoracic Support Pad(s) must be marked, otherwise none will be supplied)

QR Thoracic System, No Pad, (RHS) *TS2 RH*

QR Thoracic System, No Pad, (LHS) *TS2 LH*

Medium Thoracic Pad & Cover (140mm x 100mm) *TS2 MP*

Large Thoracic Pad & Cover (170mm x 120mm) *TS2 LP*

L

R